

City of Baraboo Street Map

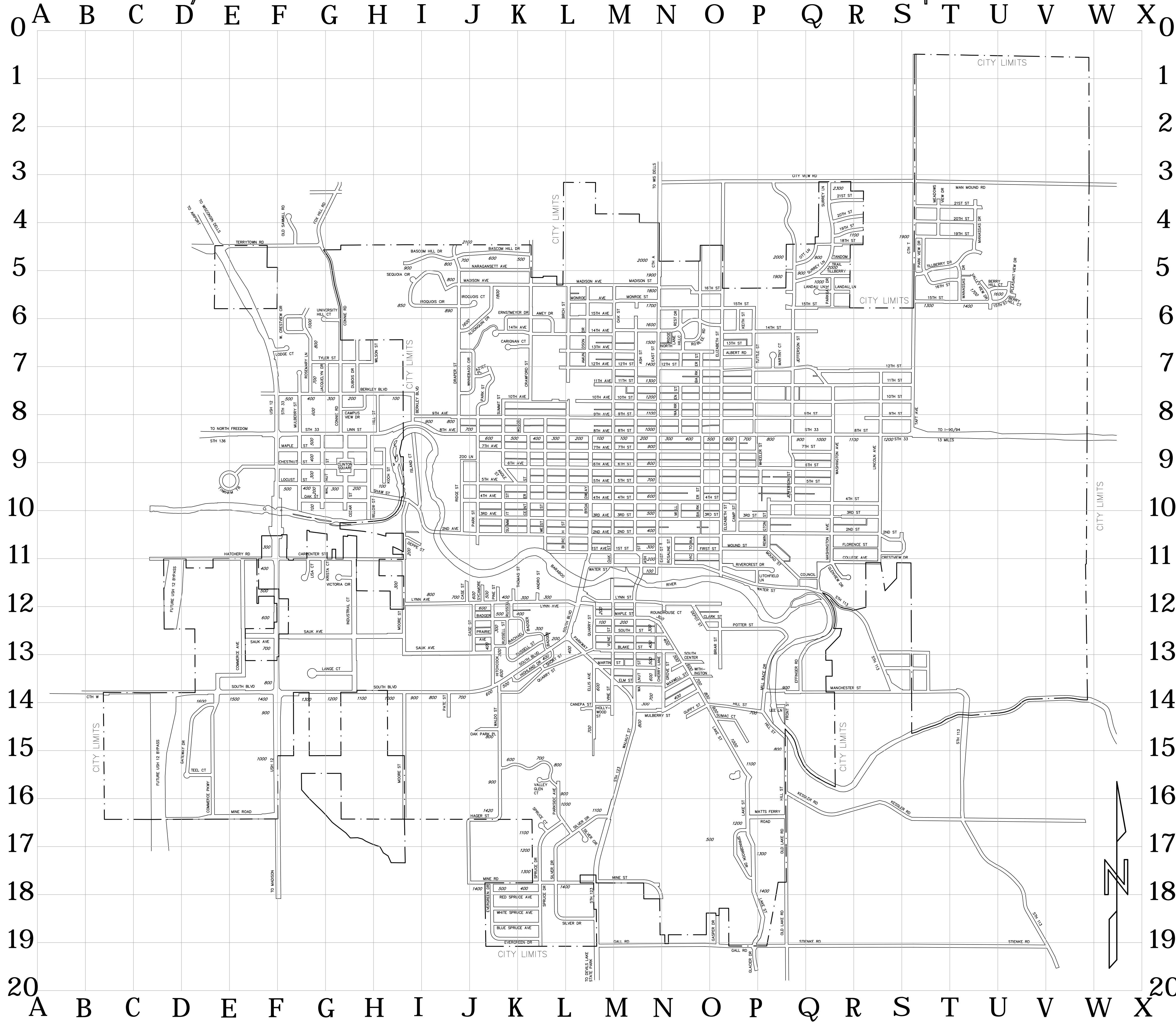

STREET	GRID	STREET	GRID	STREET	GRID
ALBERT RD	O-P, 6-7	LAKE ST	M-P, 12-19	S.T.H. 113	Q-V, 12-19
ALGONQUIN DR	J-K, 5-9	LANDAU LN	Q-R, 5-6	S.T.H. 123	L-M, 13-20
AMEY DR	K-L, 6-7	LANGE CT	G, 13-14	S.T.H. 33	F-W, 8-9
AMUNDSON DR	L-M, 5-7	LINCOLN AVE	R-S, 7-11	SUMAC CT	O-P, 14-15
ANGLE ST	K-L, 12	LISA CT	F-G, 11-12	SUMMIT ST	K-K, 7-11
ASH ST	J-K, 9-10	LITCHFIELD LN	P, 11-12	SURREY LN	P-R, 3-6
AZTEC PL	M-N, 5-12	LYNN AVE	I-L, 12	SYCAMORE ST	J, 12
BADGER DR	J-K, 7-8	LYNN ST	L-P, 12	TAFT AVE	S-T, 1-9
BARKER ST	J-L, 12-13	MADISON AVE	J-M, 5-6	TANDUM TR	Q-R, 4-5
BASCOM HILL DR	N-O, 6-11	MADISON ST	M-O, 5-6	TEEL COURT	D-E, 15-16
BASCOM HILL DR	H-L, 4-5	MANASSAS DR	T-U, 4-6	THOMAS ST	K, 12
BERKLEY BLVD	E-H, 7-9	MANCHESTER DR	P-S, 14	TILLBERRY DR	Q-R, 5
BERRY HILL CT	T-V, 5-6	MAN MOUND RD	S-W, 3	TUTTLE ST	P, 6-8
BIRCH ST	L, 5-11	MAPLE ST	L-N, 12-13	U.S.H. 12	D-F, 3-18
BLAKE ST	L-O, 13	MARTIN ST	L-N, 13-14	VALLEY GLEN CT	K-L, 15-16
BLUE SPRUCE AVE	J-L, 18-19	MARTINY CT	P-Q, 7	VALLEY VIEW DR	T-U, 5-6
BRIAR ST	O-P, 12-14	MATT'S FERRY RD	P, 16-17	VICTORIA CIR	G-H, 11-12
BROADWAY	L-M, 8-12	MAXWELL ST	N-O, 13-14	VICTORIA ST	N-O, 11
CAMP ST	O-P, 8-11	MEADOWS VIEW DR	S-T, 4-5	VINE ST	M, 11-14
CANAPA ST	L-M, 14	MILL ST	N-O, 10	WALDO ST	J-K, 13-17
CARIGNAN CT	J-L, 6-7	MILL RACE DR	P-Q, 12-14	WALNUT ST	Q-R, 11-19
CARPENTER ST	F-I, 11	MINE RD	J-M, 17-18 & C-F, 14-17	WARREN ST	N-O, 7-9
CASE ST	J, 12-13	MONROE AVE	M-N, 16-17	WASHINGTON AVE	Q-R, 7-12
CENTER ST	K-L, 8-11	MONROE ST	L-M, 5-6	WATER ST	L-T, 11-14
CHERY LN	M-N, 12-14	MONROE ST	M-N, 5-6	WEST ST	K-L, 8-11
CLARK ST	O, 12	MOORE ST	H-I, 10-16	WHEELER ST	P, 9
CITY VIEW RD	N-S, 3	MOUND ST	O-Q, 10-12	WHITE SPRUCE AVE	K, 17-19
COLLEGE AVE	Q-S, 11	MULBERRY ST	M-O, 14	WINNEBAGO CIR	J, 6-8
COMMERCE AVE	D-F, 11-14	NARAGANSETT AVE	I-L, 5	WITHINGTON ST	O, 13-14
COMMERCE PKWY	D-E, 14-17	NORTHBRIDGE LN	N, 6-7	WOOD ST	K, 8-9
CONNIE RD	D-G, 8-11	OAK ST	M, 5-11	ZOO LN	J, 9
COUNCIL ST	Q, 11-12	OAK PARK PL	J-K, 14-15	1 ST AVE	K-M, 11
CRAWFORD ST	K-L, 4-8	OLD LAKE RD	P-Q, 16-19	2 ND AVE	M-O, 11
CRESTVIEW DR	R-S, 10-11	OTT LN	Q, 4-5	3 RD AVE	H-M, 10-12
C.T.H. A	N, 3-9	PARK ST	J-K, 7-11	4 TH AVE	J-M, 10
C.T.H. T	S-T, 0-9	PARKGATE DR	Q-R, 5-6	5 TH AVE	M-S, 10
C.T.H. W	B-E, 14	PARKSIDE AVE	J-L, 15-16	6 TH AVE	J-M, 9-10
DEPOT ST	N-Q, 12-13	PARKWAY	L-N, 13-14	7 TH AVE	M-S, 9-10
DEPPE ST	H-I, 10-11	PARK VIEW DR	S-T, 4-5	8 TH AVE	J-M, 9-10
DRAPER ST	I-J, 4-8	PATE ST	I, 14	9 TH AVE	M-R, 9-10
EAST ST	N, 4-11	PINE ST	J-K, 12	10 TH AVE	K-M, 9
EFFINGER RD	P-R, 12-14	PLEASANT VIEW DR	U-V, 5-6	11 TH AVE	M-S, 9
ELIZABETH ST	O-P, 3-12	POTTER ST	Q-Q, 12-13	12 TH AVE	J-M, 8-9
ELLIS AVE	L-M, 13-15	PRAIRIE AVE	J-K, 12-13	13 TH AVE	M-S, 8-9
ELM ST	M-N, 13-14	QUARRY ST	J-M, 11-14	14 TH AVE	I-M, 8-9
ERNSTMEYER DR	K, 6	RACHAEL RD	J-L, 12-13	15 TH AVE	M-W, 8-9
EVERGREEN DR	J-K, 18-19	RED SPRUCE AVE	J-L, 18	16 TH AVE	I-M, 8
FLORENCE ST	Q-S, 10-11	REMINGTON ST	P-Q, 9-11	17 TH AVE	M-S, 8
GALL RD	L-Q, 19	RIDGE ST	I, 9-11	18 TH AVE	K-M, 7-8
GATEWAY DR	D, 14-16	RIVERCREST DR	O-Q, 11-12	19 TH AVE	M-SJ, 7-8
GLENVIEW DR	Q-R, 11-12	ROBLEE RD	N-O, 4-7	20 TH AVE	M, 7-8
GROVE ST	N, 13-14	ROSLINE ST	N-O, 10-11	21 ST AVE	M-S, 7-8
GUPPY ST	P, 14	ROUNDHOUSE CT	N, 12	22 ND AVE	L-M, 7
HAGER ST	J, 16-18	RUSSELL ST	J-L, 12-13	23 RD AVE	M-S, 7
HATCHERY RD	C-F, 11	SAUK AVE	E-K, 12-13	24 TH AVE	L-M, 6-7
HIGHLAND DR	K-L, 13-14	SEQUOIA CIR	I, 5	25 TH AVE	M-P, 6-7
HILL ST	O-Q, 14-16	SHORT ST	K-L, 13-14	26 TH AVE	J-M, 6-7
HILLCREST DR	N-O, 5-7	SILVER CIR	L-M, 16-17	27 TH AVE	M-Q, 6-7
HITCHCOCK ST	J-K, 13-14	SILVER DR	K-M, 16-19	28 TH AVE	L-M, 6
HOLLYWOOD ST	M, 14	SOUTH BLVD	B-M, 11-14	29 TH AVE	S-U, 5-6
INDUSTRIAL CT	G-H, 11-14	SOUTH CENTER ST	O-P, 13-14	30 TH AVE	S-T, 5-6
IROQUOIS CIR	H-J, 5-6	SOUTH ST	L-N, 12-13	31 ST AVE	Q-R, 4-5
IROQUOIS CT	J, 5-6	SPRINGBROOK DR	O-P, 16-18	32 ND AVE	Q-U, 4-5
ISLAND CT	I, 8-10	SPRUCE CT	K-L, 16-17	33 RD AVE	Q-U, 4
JEFFERSON ST	P-Q, 3-10	SPRUCE DR	K-L, 16-19	34 TH AVE	Q-U, 3-4
KEITH ST	O-P, 6				
KRISTA CT	G, 11-12				

On-Street Parking Restrictions

All streets within the city limits have a 24-hour parking restriction year-round.

Wintertime alternate-side parking regulations go into effect on October 1 of each year to April 15th. These regulations require that vehicles parked on the street between the hours of 1:00 a.m. and 6:00 a.m. be parked on the even-numbered side of the street on even-numbered dates and on the odd-numbered side of the street on odd-numbered dates.

Motorists should remember that the rule is in effect only during the early morning hours--when parking in the evening, park on the appropriate side for the following day's date.

MAP SCALE: 1 GRID SQUARE = 1000 FEET
APPROXIMATE ADDRESS NUMBERS SHOWN IN SMALL TEXT

BARABOO CITY HALL IS LOCATED AT 135 FOURTH STREET AND IS OPEN WEEKDAYS FROM 7:30 UNTIL 4:30. PHONE US AT 355-2700

FOR MORE CITY OF BARABOO INFORMATION PLEASE VISIT OUR WEBSITE AT WWW.CITYOFBARABOO.COM OR VISIT US ON FACEBOOK AT CITY OF BARABOO